

1.

()

() Ballscrew Clean , ,

DRM-C Series

1.1.

가

, “2. ” 가

:

가

:

가

:

End Effector

가

()

2.

2.1.

: 가 ,
가 .
.
가
가
가
(250mm/sec) 가 .
가

:
가
가
가
(Body가 Body)가

: Size
가
가
가
가
가

: Stroke
.

: 가 가

: 가
가

2.2.

<input type="text"/>	:	가	.
<input type="text"/>	:	, 가 , 가 가	.
<input type="text"/>	:	Stroke Damper Slider가 Damper가 Slider가 Damper	" 8.
<input type="text"/>	:		.
<input type="text"/>	:	(: 0.1mm)	.
<input type="text"/>	:	End Effector* Slider	, 6.8, 6.9
<input type="text"/>	:		.
<input type="text"/>	:		.
<input type="text"/>	:	0~40	, ,
<input type="text"/>	:	Clean Class 100	.

* End Effector : Gripper, Holder,

3.

Clean Class 100

Stainless Steel Band가

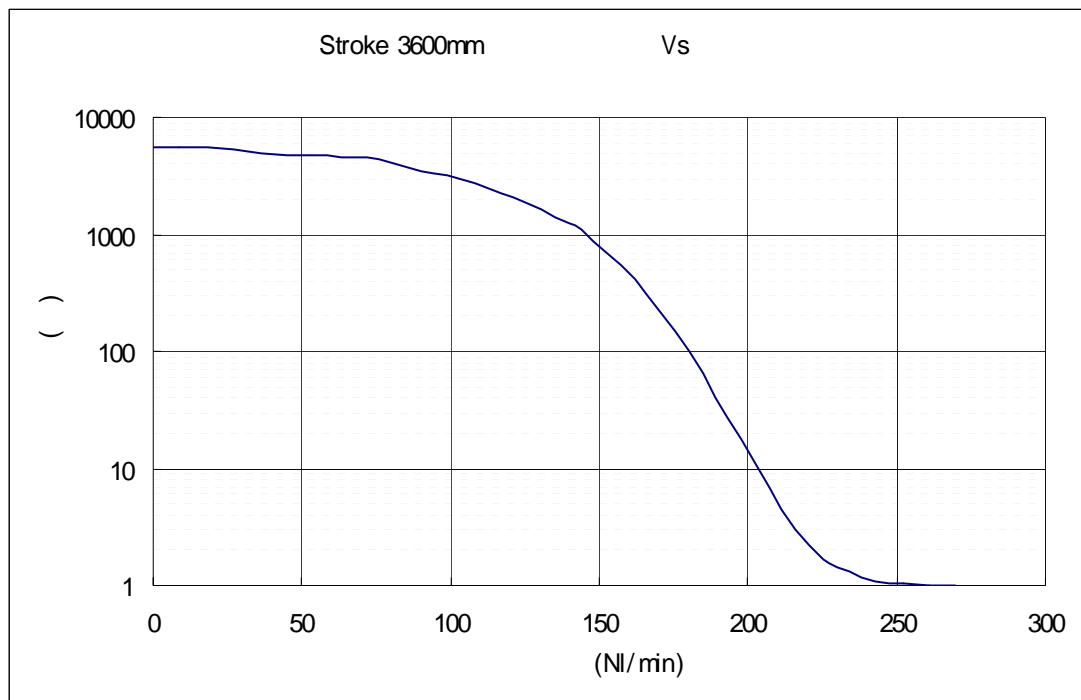

Ballcrew Linear Motion Guide

가

AC Servo Motor

가 가

Compact

Design

4.

4.1.

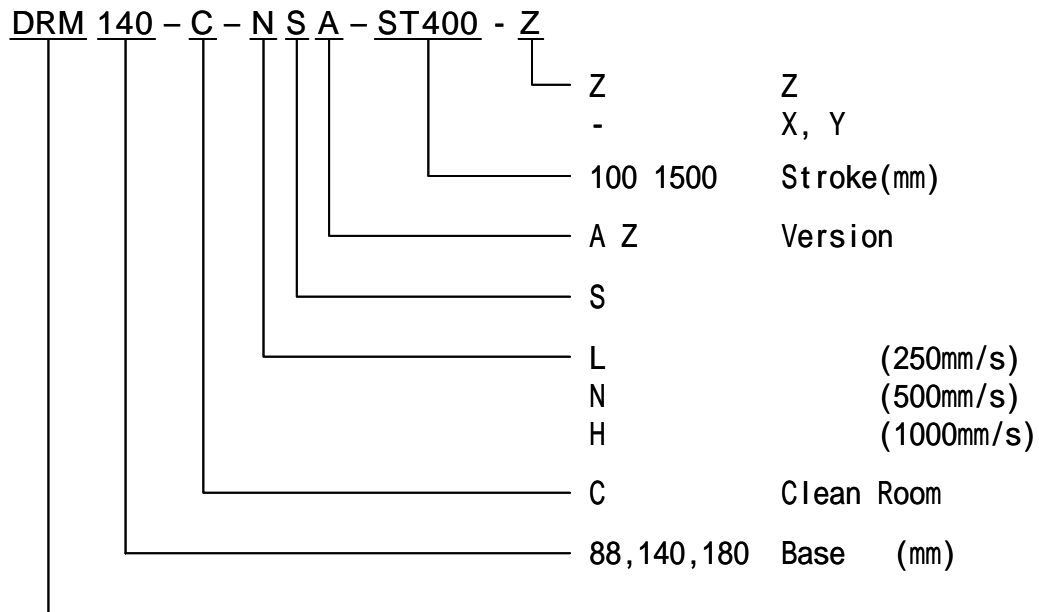

4.2.

Base		Stroke		Pay Load		Motor(AC Servo)
mm		mm	mm/sec	kgf	mm	Watt
88	DRM 88 - C - NSA	100 ~800	500	15	±0.02	100
	DRM 88 - C - HSA		1000	10		100
	DRM 88 - C - NSA - Z		500	7		100(BRAKE)
	DRM 88 - C - LSA - Z		250	15		100(BRAKE)
140	DRM140 - C - NSA	200 ~1100	500	40		200
	DRM140 - C - HSA		1000	25		200
	DRM140 - C - NSA - Z		500	20		200(BRAKE)
	DRM140 - C - LSA - Z		250	35		200(BRAKE)
180	DRM180 - C - NSA	200 ~1500	500	70		400
	DRM180 - C - HSA		1000	40		400
	DRM180 - C - NSA - Z		500	35		400(BRAKE)
	DRM180 - C - LSA - Z		250	45		400(BRAKE)

5.

5.1.

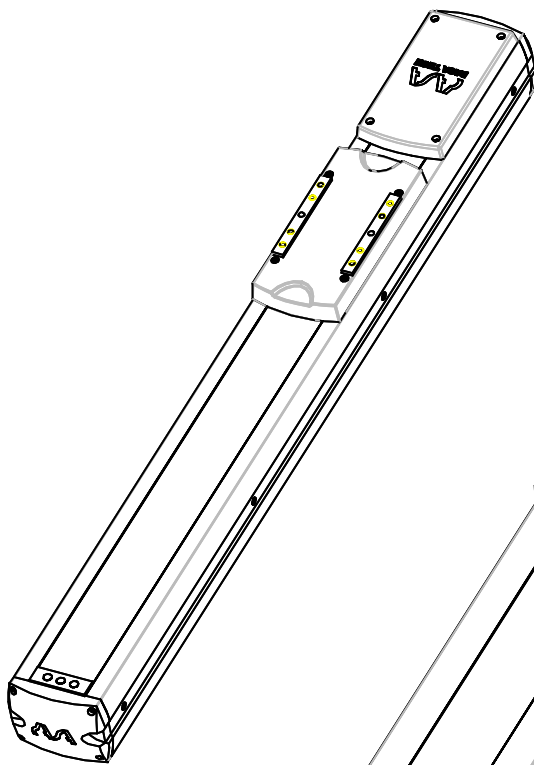

DRM88-C-NSA

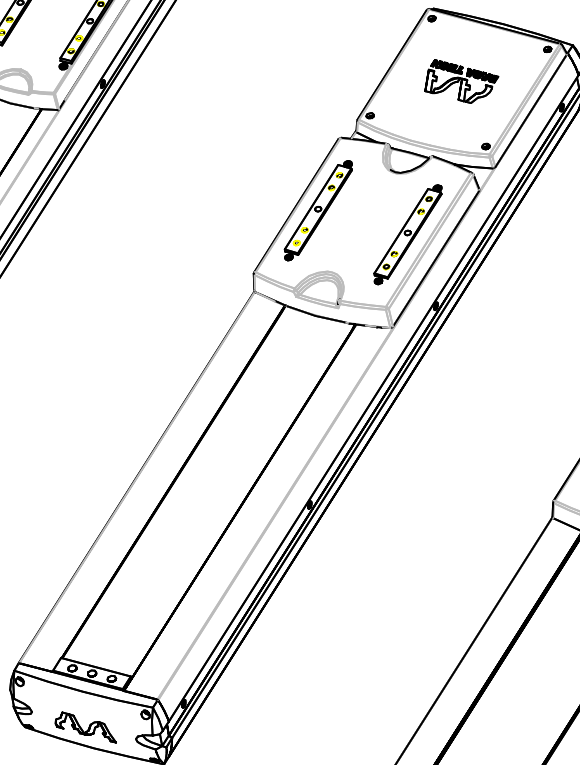

DRM140-C-NSA

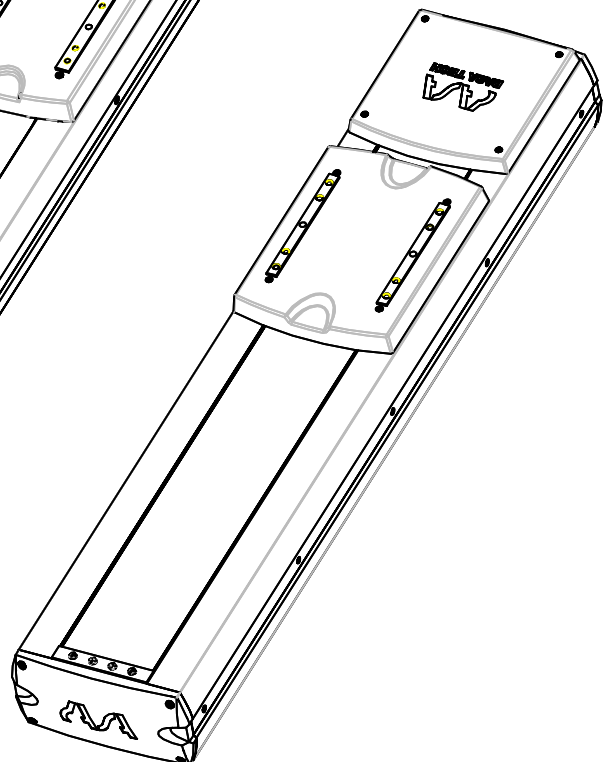

DRM180-C-NSA

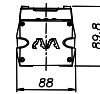
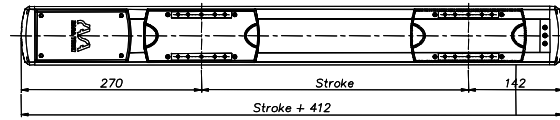

DRM88-C-NSA

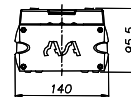
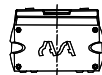
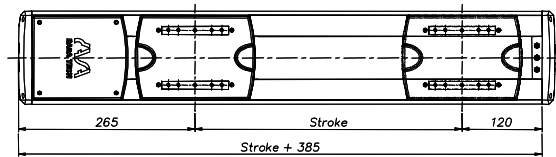

DRM140-C-NSA

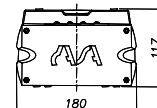
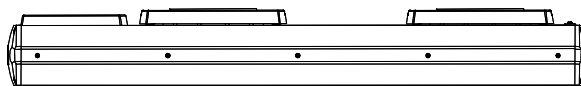
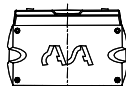
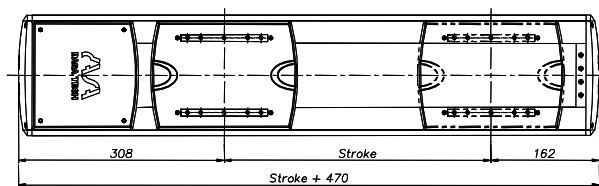

DRM180-C-NSA

Slider

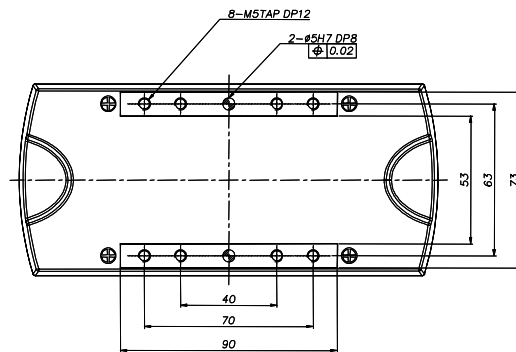

DRM88-C-NSA SLIDER

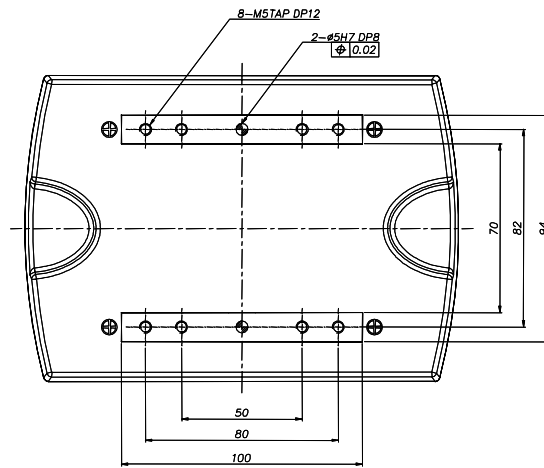

DRM140-C-NSA SLIDER

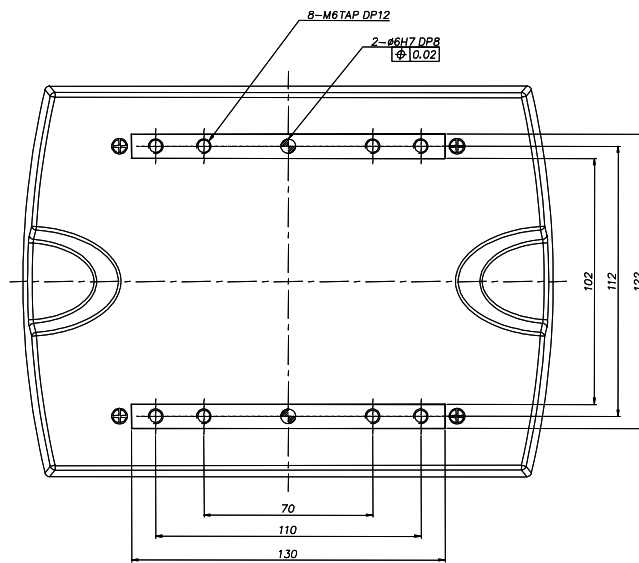

DRM180-C-NSA SLIDER

5.2.

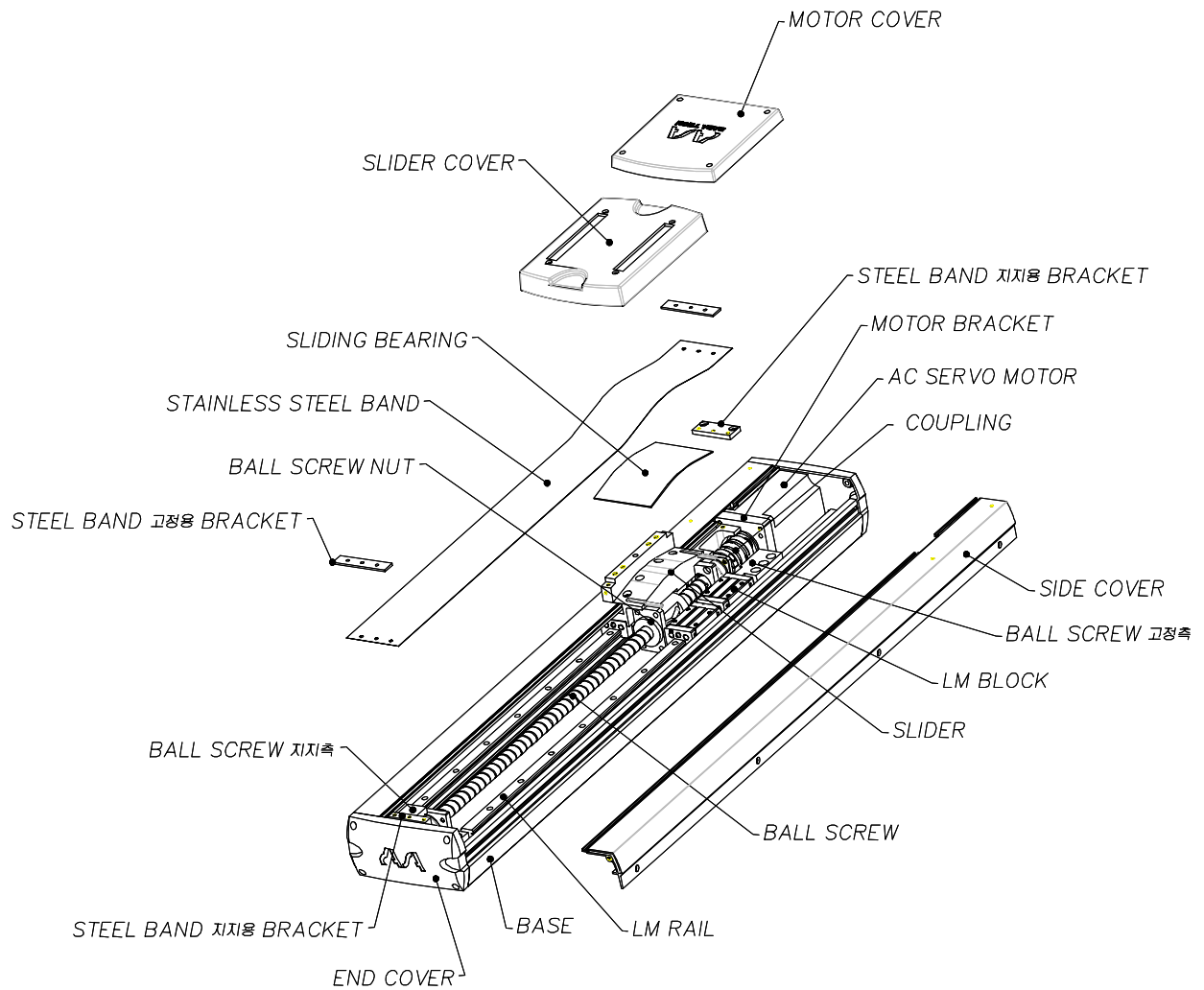

6.

6.1.

가 .
,

:

가 ,
.

6.2.

:

가 가 ,
가 가 .

1) .

2) .
가 .

3) .
가 .

4) 가 .

6.6.

Stroke

Limit Sensor가

6.7.

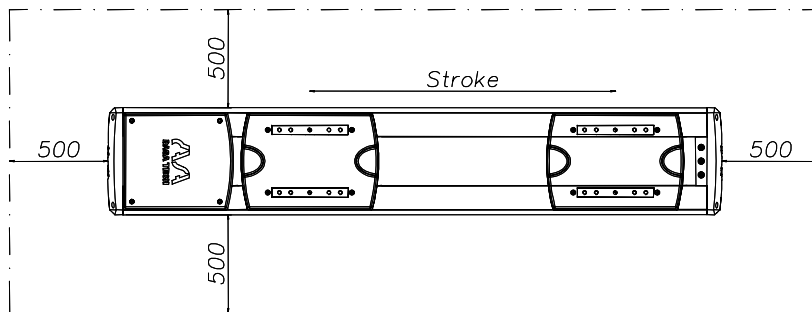

6.8.

Tap

()

가 0.1mm

Bracket

10mm

DRM88 - C - NSA

TAP

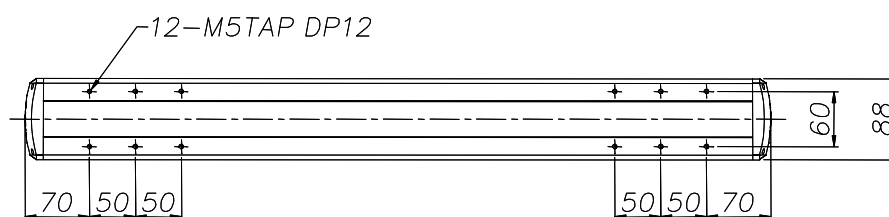

Clean

DRM-C SERIES

DRM140 - C - NSA DRM180 - C - NSA

Slot

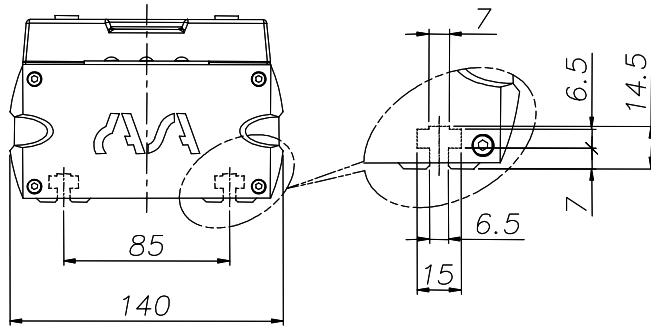

DRM140 - C - NSA SLOT

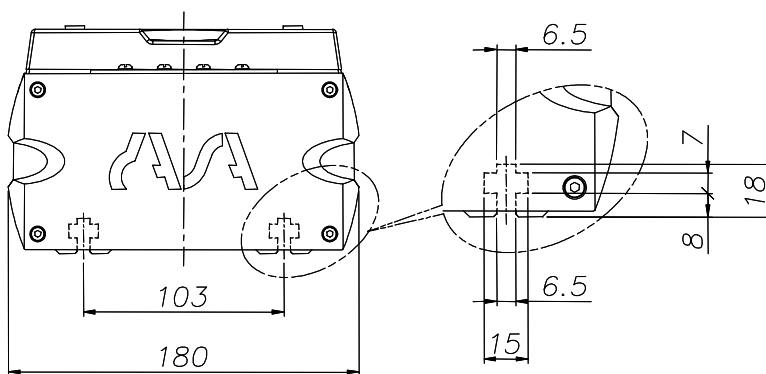
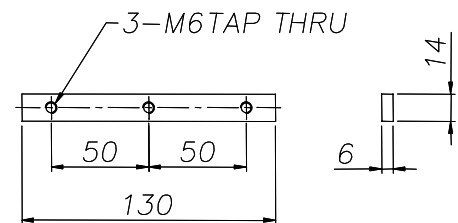

DRM180 - C - NSA SLOT

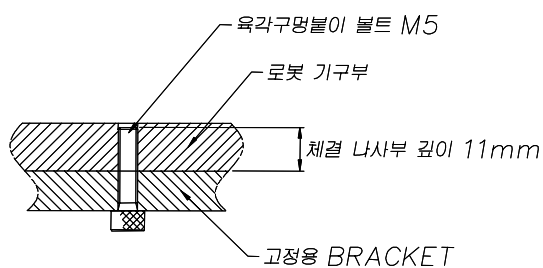

M5 BOLT : 5N·m(45 kgf·cm)
DRM88 - C - NSA

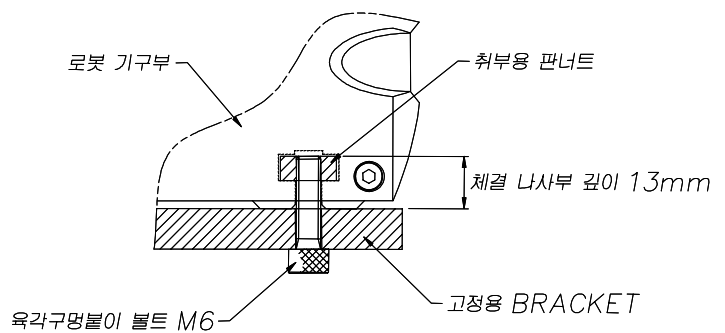

M6 BOLT : 7.1N·m(70 kgf·cm)
DRM140/180 - C - NSA

Clean

DRM-C SERIES

6.9. End Effector

Slider	Tap	End Effector	.
- M5		Torque : 5 N · m(45 kgf · cm)	
- M6		Torque : 7.1 N · m(70 kgf · cm)	
Tap	Pin Hole	" 5.1.	"

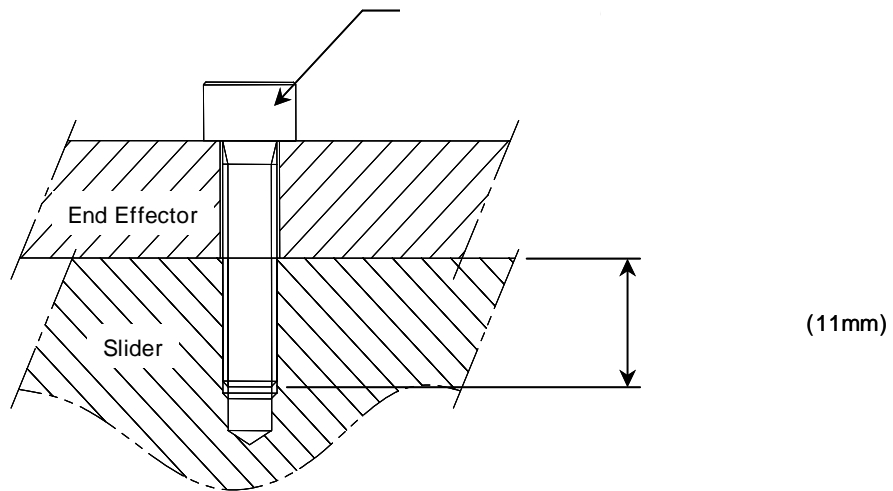

7.

Clean Class 100

0~40

	1 /1		7.1.
	1 /6	Ball Screw, Tape, Stainless Steel Band	7.2.
	1 /	LM Guide	7.2.

*

	(Hr)
LM Guide	35,000
Ball Screw	15,000

7.1.

:

가 가	
End Effector가 가	

7.2.

7.2.1. Ball Screw LM Guide

Ball Screw	LG2 (NSK Grease)	1 / 6	Shaft
LM Guide		1 / 1	Nipple

7.2.1. Tape Stainless Steel Band

Tape Stainless Steel Band () .

: Stainless Steel Band 가

: Stainless Steel Band 가

Stainless Steel Band 가 가	Sweeper IPA .
Stainless Steel Band 가	1) Stainless Steel Band .
Tape 가	2) Tape .

1) Stainless Steel Band

Slider Cover

Motor Cover

Motor

Motor

Stainless Steel Band

Bracket

Stainless Steel Band

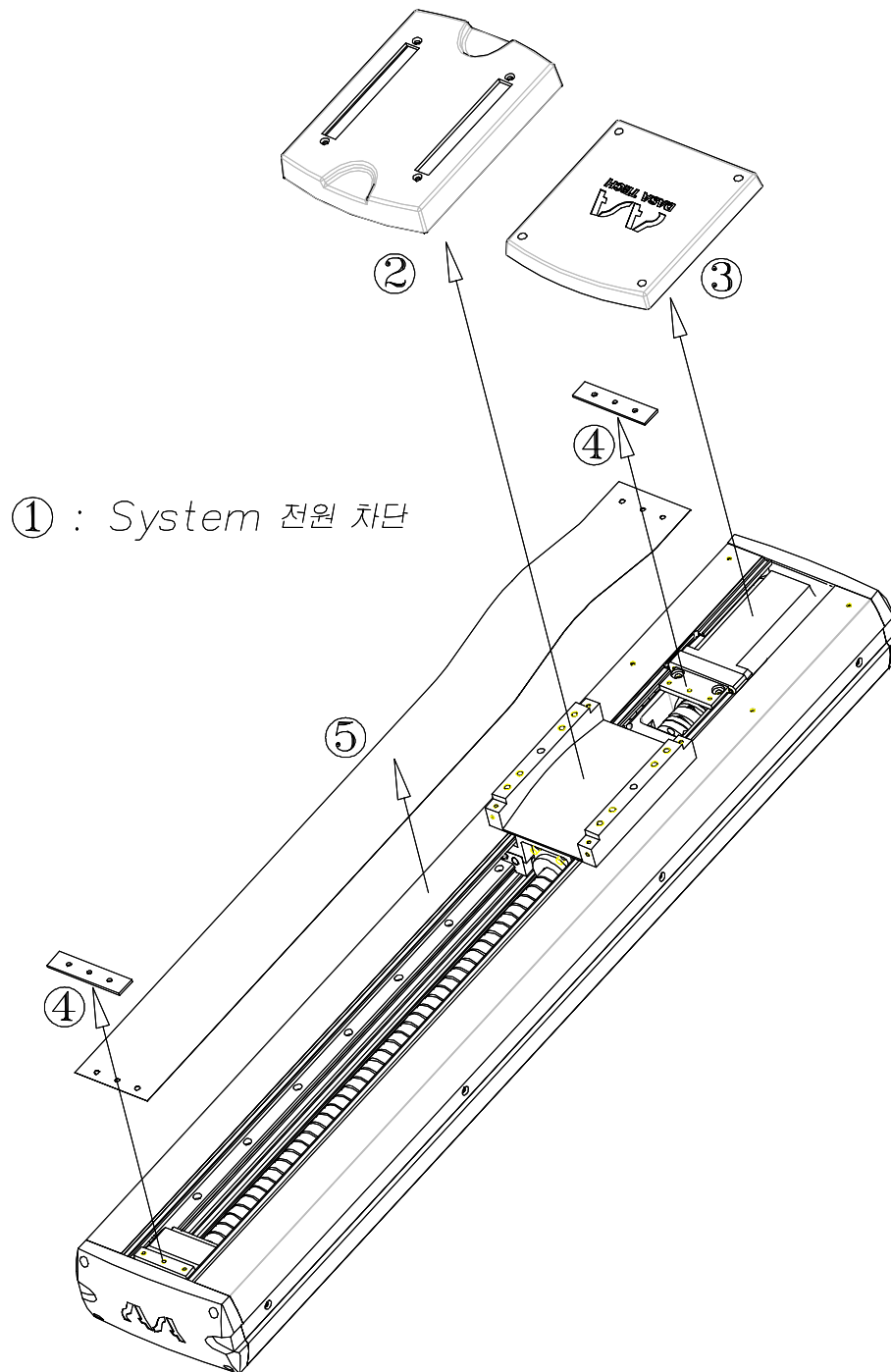

Stainless Steel Band

, Stainless Steel Band

2) Tape

1) Slider Cover

Slider

Tape

Tape

Slider

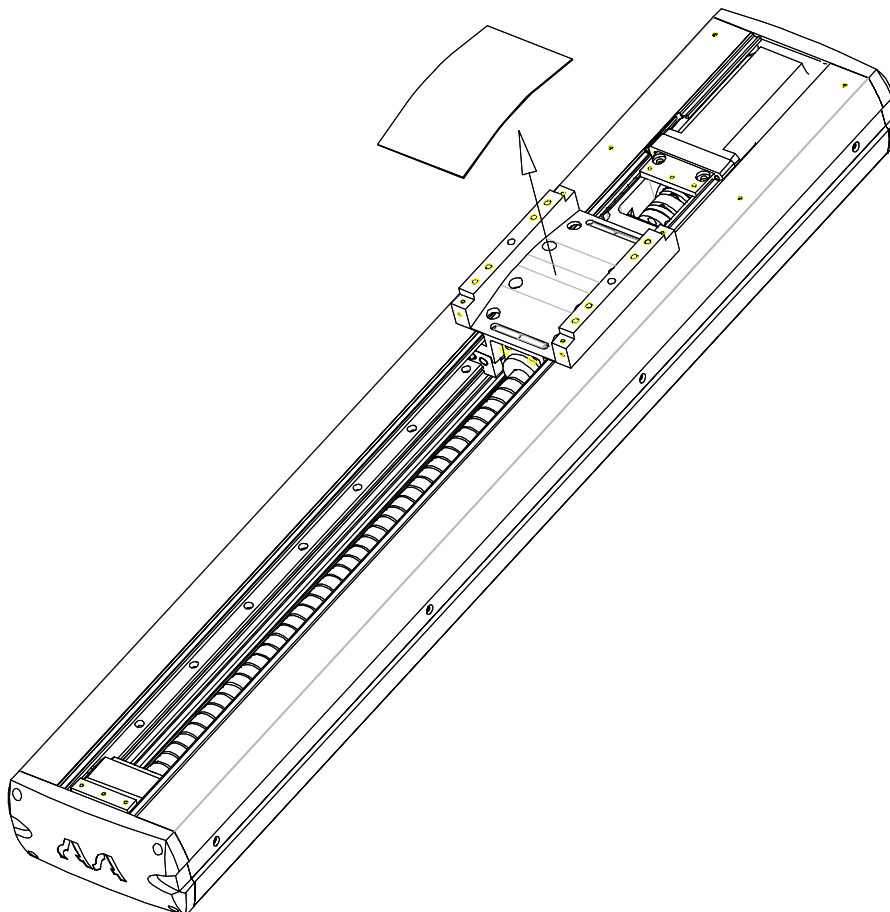

: Tape Slider가 가
가 . Slider가

: Stainless Steel Band
Slider Stainless Steel Band Stainless Steel Band가
가

7.3.

	1) ()	Thickness Tape ()
	2)	
	3)	
	4)	(가)
	5)	
	6) Gain	P, I Gain
	7) 15000 가	
	8) 35000 가	
	9) Brake	Brake
	10)	
	1)	
	2) 가	가
	3)	
	4)	가 가
	5)	가
	6) Gain	P, I Gain
	7)	가
	1)	
	2) ()	Thickness Tape ()
	3) Position Gain	Position Gain
	4)	가 가
	5)	
	6)	
	1) Lead	가
Limit() Sensor	1) Reed Switch Magnet	Reed Switch (2.5mm)
	2) Reed Switch	Reed Switch
	3) Parameter	Parameter
	1) Cable	Cable
	2) Cable Veyor Cable	Cable Veyor
	3) Connector	Connector
가	1) Pitch/Rev(Gear Ratio)	Pitch/Rev(Gear Ratio)
	2) Sensor Encoder Z	Z Pulse 1000~7000

8.

Slider Damper

